

| SCHEDULE OF DOORS AND WINDOWS |                       |                           |            |  |
|-------------------------------|-----------------------|---------------------------|------------|--|
| TYPE                          | SIZE                  | ALL LVL.                  | LEVEL LVL. | DESCRIPTION                                      |
| RS                            | 3000X2100             | ±0.000M                   | +2.100MM   | FOLDABLE DOOR FOR SHOP                           |
| D1                            | 1000X2100             | ±0.000M                   | +2.100MM   | ROLL GATE FOR PARKING HALL                       |
| D1A                           | 3000X2100             | ±0.000M                   | +2.100MM   | ALUMINIUM FRAME GLASS SHUTTER                    |
| D2                            | 1000X2100             | ±0.000M                   | +2.100MM   | F.R. SHEET FRAME FLUSH DOOR SHUTTER              |
| D3                            | 1000X2100             | ±0.000M                   | +2.100MM   | F.R. SHEET FRAME FLUSH DOOR SHUTTER              |
| D4                            | 3000X2100             | ±0.000M                   | +2.100MM   | F.R. SHEET FRAME FLUSH DOOR SHUTTER              |
| D5                            | 1000X2100             | ±0.000M                   | +2.100MM   | BLUSHIRE BRAND FRAME AND SHUTTER                 |
| D6                            | 1500X2100             | ±0.000M                   | +2.100MM   | BLUSHIRE BRAND FRAME AND SHUTTER                 |
| W1                            | 2100X1350             | ±0.000M                   | +2.100MM   | ALUMINIUM FRAME GLASS SHUTTER                    |
| W1A                           | SHOW IN WINDOW DETAIL |                           |            | ALUMINIUM FRAME GLASS SHUTTER                    |
| W1B                           | 2100X1800             | ±0.000M                   | +2.250MM   | ALUMINIUM FRAME GLASS SHUTTER                    |
| W2                            | 1575X1350             | ±0.000M                   | +2.100MM   | ALUMINIUM FRAME GLASS SHUTTER                    |
| W2A                           | SHOW IN WINDOW DETAIL |                           |            | ALUMINIUM FRAME GLASS SHUTTER                    |
| W2B                           | 1575X1800             | ±0.000M                   | +2.250MM   | ALUMINIUM FRAME GLASS SHUTTER                    |
| W3                            | 1500X1350             | ±0.000M                   | +2.100MM   | ALUMINIUM FRAME GLASS SHUTTER                    |
| W3A                           | SHOW IN WINDOW DETAIL |                           |            | ALUMINIUM FRAME GLASS SHUTTER                    |
| W4                            | 1000X1350             | ±0.000M                   | +2.100MM   | ALUMINIUM FRAME GLASS SHUTTER                    |
| W4A                           | SHOW IN WINDOW DETAIL |                           |            | ALUMINIUM FRAME GLASS SHUTTER                    |
| W5                            | 1000X1350             | ±0.000M                   | +2.100MM   | ALUMINIUM FRAME GLASS SHUTTER                    |
| V                             | 375X1200              | ±0.000M                   | +2.100MM   | ALUMINIUM FRAME GLASS VENTILATOR                 |
| V1                            | 1800X1350             |                           |            | ALUMINIUM FRAME GLASS SHUTTER FINISH FOR SHARJAH |
| V2                            | 2400X3600             | AS MENTIONED IN ELEVATION |            | ALUMINIUM FRAME GLASS SHUTTER FINISH FOR SHARJAH |
| V1A                           | 1800X600              | ±1.500MM                  | +2.100MM   | ALUMINIUM FRAME GLASS VENTILATOR                 |
| D1                            | 1000X500              | AS MENTIONED IN ELEVATION |            | ALUMINIUM FRAME GLASS SHUTTER FINISH             |

WALL UP TO 2100MM HEIGHT

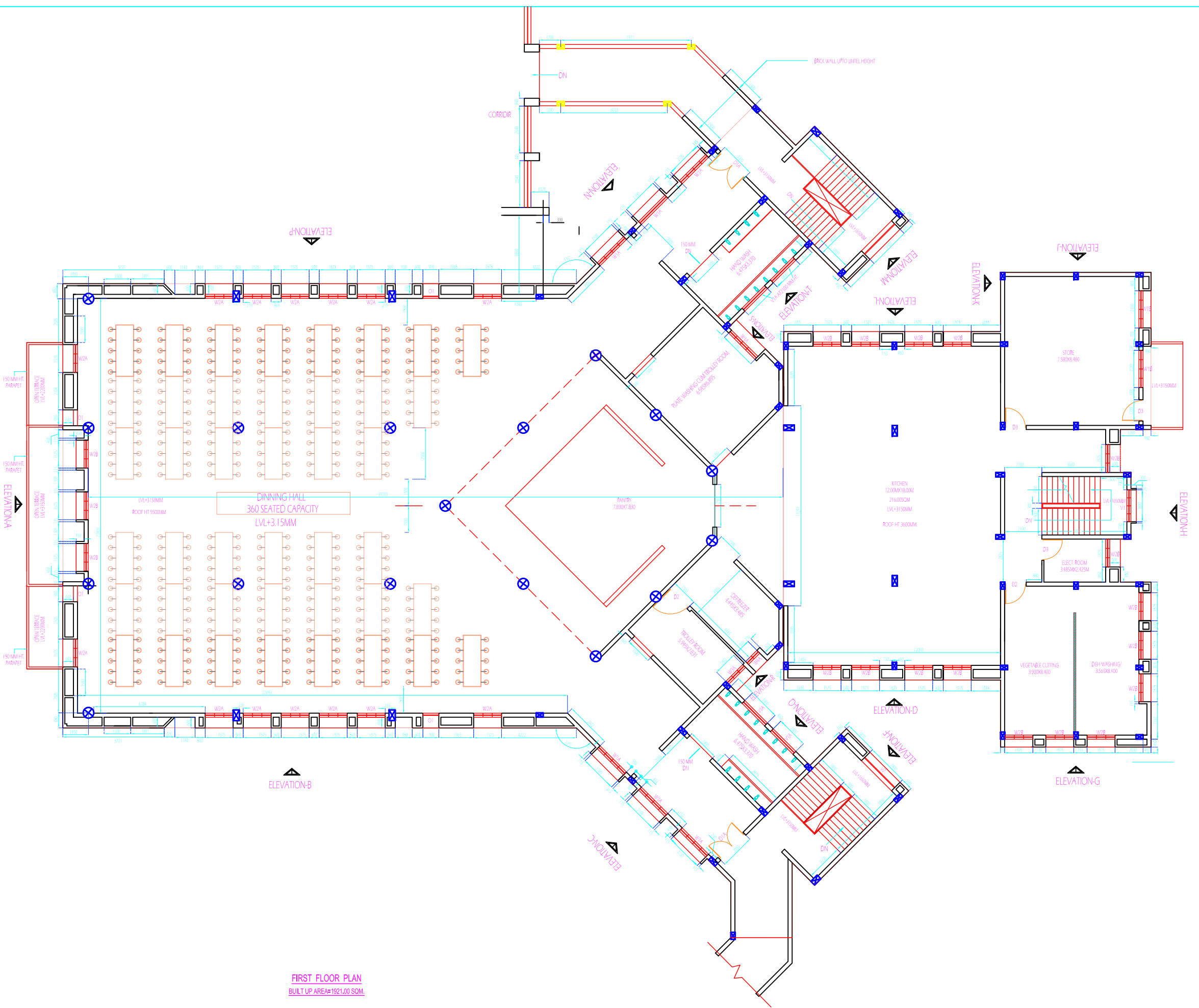

FIRST FLOOR PLAN  
BUILT UP AREA=1921.00 SQM.

| REV./SUFFIX  | DESCRIPTION | DEALT BY                    | DATE                      |
|--|-------------|-----------------------------|---------------------------|
| PROJECT<br>PROPOSED DINING HALL FOR HALL OF RESIDENCE 2&3<br>FOR<br>NATIONAL INSTITUTE OF TECHNOLOGY, ROURKELA<br>CONSULTANT |             |                             |                           |
| TITLE<br>M. VISWESWARIYA - G.D.BIRLA<br>HALL OF RESIDENCE.   |             |                             | DATE<br>19-05-11<br>NORTH |
| ARCHITECT<br>AR. B.K. BEHERA<br>CA/98/23572  | DRN. BY.    | DRG. NO.<br>019/09/03/04/01 | SCALE<br>1:100            |
| APPROVED BY:   |             |                             |                           |